

N 21.00
E 10.00

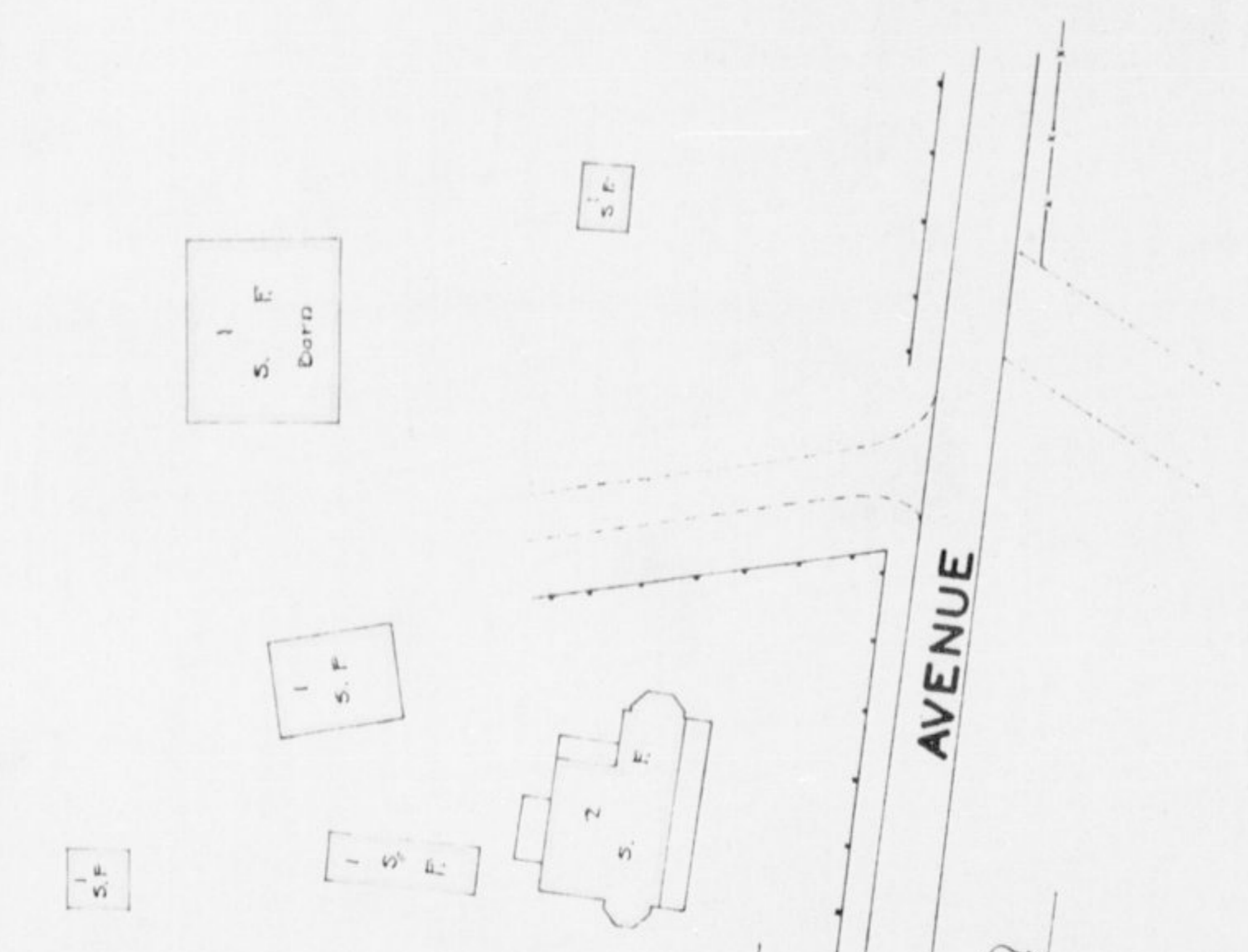

HAMILTON AVENUE
As Now in Process of Construction
Ord. No. 255 Approved May 21, 1928

John W. & Robert Garrett

HILLEN ROAD

N. 03° 44' 00" E
82.03'

E 9449 G3
N. 21° 00' 00" E

E 9465 40
N. 21° 07' 10"

295.41

ROAD

M 4783 - 4D