

COMMISSIONERS
Clerk
CITY SURVEYOR

PLAT A & B
FOR THE CONDEMNATION AND OPENING OF
BELVEDERE AVENUE
FROM
A POINT 256.77 FEET EAST OF YORK ROAD
TO HILLEN ROAD
IN ACCORDANCE WITH ORDINANCE NO. 364.
MAYOR AND CITY COUNCIL OF BALTIMORE
APPROVED: APR. 23, 1928.
SCALE: 1 INCH = 40 FEET.

M 4784 - 4D

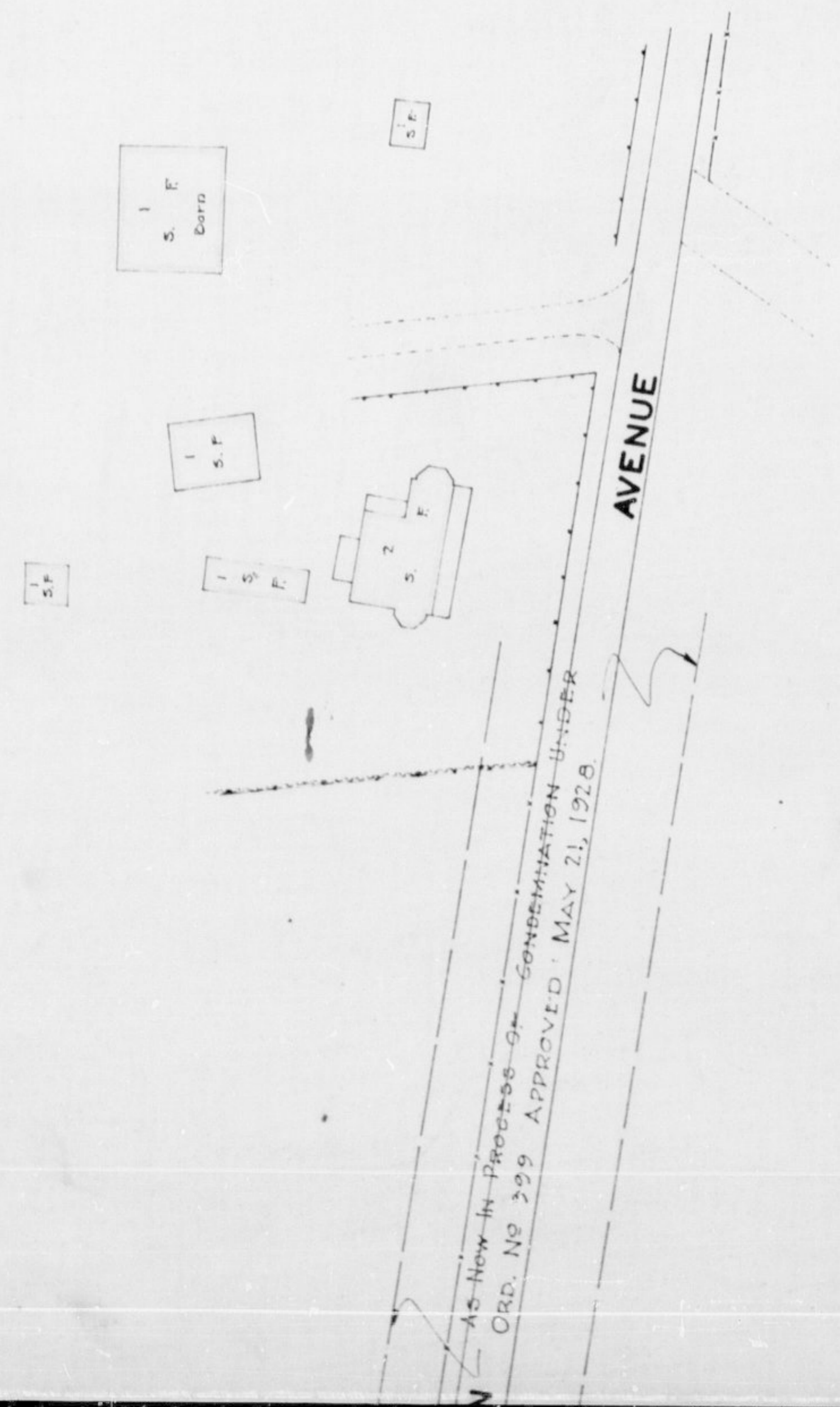

As Now in Process of
REC. NO. 299 APPROVED MAY 21, 1928

John W. & Robert Garrett

SCALE: 1 INCH = 10,000