

276-A

- A, B, C, D, E, F, G, H, I, J, K, L, M, N, O, P, Q, R, S, T, U, V, W, X, Y, Z
- 1- MARY M. DODD FOR LIFE, LEASEHOLD, DWIGHT M. DODD, DEVISEE, DEC. Fee Simple, Dedicated.
- J- HENRY P. RABINOWITZ, Fee Simple, Dedicated.
- N- DENNIS H. DODD & WIFE, Fee Simple.
- O- WALTER HUBBS & FIVE SONS (BY REAL ESTATE TRUST) TRUST, LESTER L. STEVENS, DEV. DEC. Fee Simple, Dedicated.
- P- R. B. MAYOR AND CITY COUNCIL OF BALTIMORE, Fee Simple, Dedicated.
- Q- The General Credit Co., Dev. Dec. Fee Simple, Dedicated.
- R- MILDRED LEE JACOBS, REV. Fee Simple, Dedicated.
- S- ADLAIDE W. MASSEY, REV. Fee Simple, Dedicated.
- T- JOHN DELIKAN, REV. Fee Simple, Dedicated.
- U- ETHEL B. BAKER, REV. Fee Simple, Dedicated.
- V- MARGARET E. TOSTER-BADHAM, REV. Fee Simple, Dedicated.
- W- THOMAS FORTUNE DISNEY VICOUNTY OF VASTRELAND LIFE TENANT, REV. Fee Simple, Dedicated.
- X- NETTIE WILSON, LEASEHOLD, ALEX. F. WOLFE FOR LIFE, REV. DEC. Fee Simple, Dedicated.
- Y- MARSHALL LEVERETT, LEASLD., THE GENERAL CREDIT CO., REV. DEC. Fee Simple, Dedicated.
- Z- FRANCIS S. CLAYTON & WIFE, Fee Simple, Dedicated.
- AA- ELA R. ALICE & A. HELEN DODD, LEASLD. ELA DREYHOFF, A. HELEN & ALICE DODD, DEV. DEC. Fee Simple, Dedicated.
- AB- HOWARD S. BELLMAN, Fee Simple, Dedicated.
- AC- MARY CLEMENT OF HER UNKNOWN HEIRS, DEVISEES, ASSIGNEES, AND THOSE PERSONS CLAIMING BY, THROUGH OR UNDER THEM, Fee Simple, Dedicated.
- AD- MARY C. LEVINE, LEASLD., ELLIOTT B. WARRER, PICKING, REV. Fee Simple, Dedicated.
- AE- MANNING ANDERSON WOODS & EVELYN SALLIE HARRIS AS JOINT TENANTS, LEASLD., SAMUEL FOX & WIFE, DEV. Fee Simple, Dedicated.
- AF- PERRY H. & LISA DOROTHY DYER AS JOINT TENANTS, LEASLD., ETHEL B. BAKER, REV. Fee Simple, Dedicated.
- AG- ARTHUR W. BAYLOR & WIFE, LEASLD. DENA FARRMAN, REV. Fee Simple, Dedicated.
- AH- JOSEPH J. LYLE & WIFE, LEASLD. DE WASHINGTON WORKSHOP FOR THE BLIND, REV. Fee Simple, Dedicated.
- AI- ILLIANA M. ROBERTS, LEASLD. JOSEPH A. CLARK THE LIFE, REV. Fee Simple, Dedicated.
- AJ- PIERCE J. WOODS & WIFE, Fee Simple, Dedicated.
- AK- JOHN G. MAIER JR., Fee Simple, Dedicated.
- AL- ALVIN E. FRIEDMAN, Fee Simple, Dedicated.
- AM- SARAH MARCEL KING, Fee Simple, Dedicated.
- AN- SARAH MARCEL KING, Fee Simple, Dedicated.
- AO- CHARLES WILLIAM DORRIS & WIFE, LEASLD. MOLLY GALEY WILSON, REV. DEC. Fee Simple, Dedicated.
- AP- MOLLY GALEY WILSON, Fee Simple, Dedicated.
- AQ- SIMON BLECHMAN & WIFE, Fee Simple, Dedicated.
- AR- SIMON BLECHMAN & WIFE, REV. DEC. Fee Simple, Dedicated.
- AS- NORMAN O. ROBINSON & WIFE, LEASLD. SIMON BLECHMAN & WIFE, REV. DEC. Fee Simple, Dedicated.
- AT- JAMES G. PARSONS, LEASLD. SARAH MARCEL KING, REV. DEC. Fee Simple, Dedicated.
- AU- JOHN & JESSE M. MATTHEWS OR THEIR UNKNOWN HEIRS, DEVISEES, ASSIGNEES, AND THOSE PERSONS CLAIMING BY, THROUGH OR UNDER THEM, Fee Simple, Dedicated.
- AV- WALTER T. SEIDEL & WIFE, Fee Simple, Dedicated.
- AW- WALTER I. HUNTER & WIFE, LEASLD. HARRY MEROWITZ, SAMUEL CASLINER & MORTON LESTER SIEBERMAN, TRUSTEES, REV. DEC. Fee Simple, Dedicated.
- AX- NICHOLAS RICE, SR. LEASLD. WILLIAM HENRY BAKER OF CARROLL COUNTY, REV. DEC. Fee Simple, Dedicated.
- AY- FRANCIS GREGORY & WIFE, LEASLD. SARAH MARCEL KING, REV. DEC. Fee Simple, Dedicated.
- AZ- MARY F. MCCRAY, LEASLD. Fee Simple, Dedicated.
- BA- DOLEINGER-LELAND CO. INC., Fee Simple, Dedicated.
- BB- VINCENT ARGENTINO & WIFE, Fee Simple, Dedicated.
- BC- CHARLES H. MILLER & WIFE, LEASLD. THEOBALD RUBENSTEIN & WIFE, REV. DEC. Fee Simple, Dedicated.
- BD- JOSEPH M. HOOD & WIFE, LEASLD. Fee Simple, Dedicated.
- BE- RICHARDSON VANE & WIFE, LEASLD. THE HOME OF THE AGED OF THE METROPOLITAN EPISCOPAL CHURCH OF BALTIMORE CITY, REV. DEC. Fee Simple, Dedicated.
- BF- GEORGE F. ALBRECHT & WIFE, Fee Simple, Dedicated.
- BG- WILLIAM J. LEER & WIFE, Fee Simple, Dedicated.
- BH- Fee Simple, Dedicated.

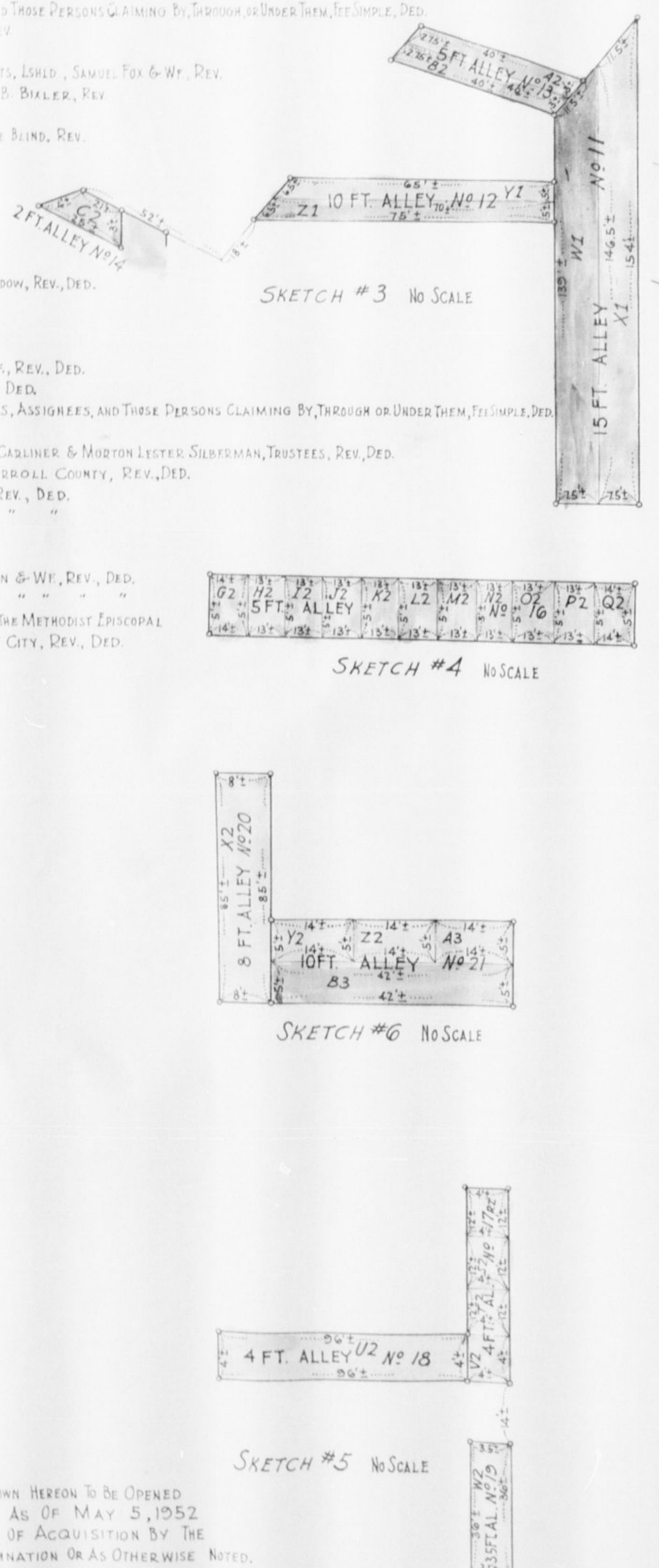

PLAT A & B
FOR THE CONDEMNATION AND OPENING
OF
CERTAIN STREETS AND ALLEYS LYING WITHIN THE
AREA BOUNDED BY 27TH STREET, MATHews STREET,
30TH STREET, 20 FOOT ALLEY EAST OF REESE STREET
AND REESE STREET

IN ACCORDANCE WITH ORDINANCE NO. 312
MAYOR AND CITY COUNCIL OF BALTIMORE
APPROVED MAY 16, 1952
SCALE 1 INCH = 50 FEET

APPROVED: DIRECTOR OF PUBLIC WORKS
DIRECTOR OF ASSESSMENTS
CLERK
ENGINEER OF SURVEYS

M 4936 — 208A

276-A-9