

220
55
265

190
99

222
99
1998
1998
155
21978/137
155

250
137
113

a
34

Golden Lyon 166^a

Siward Mann's Part

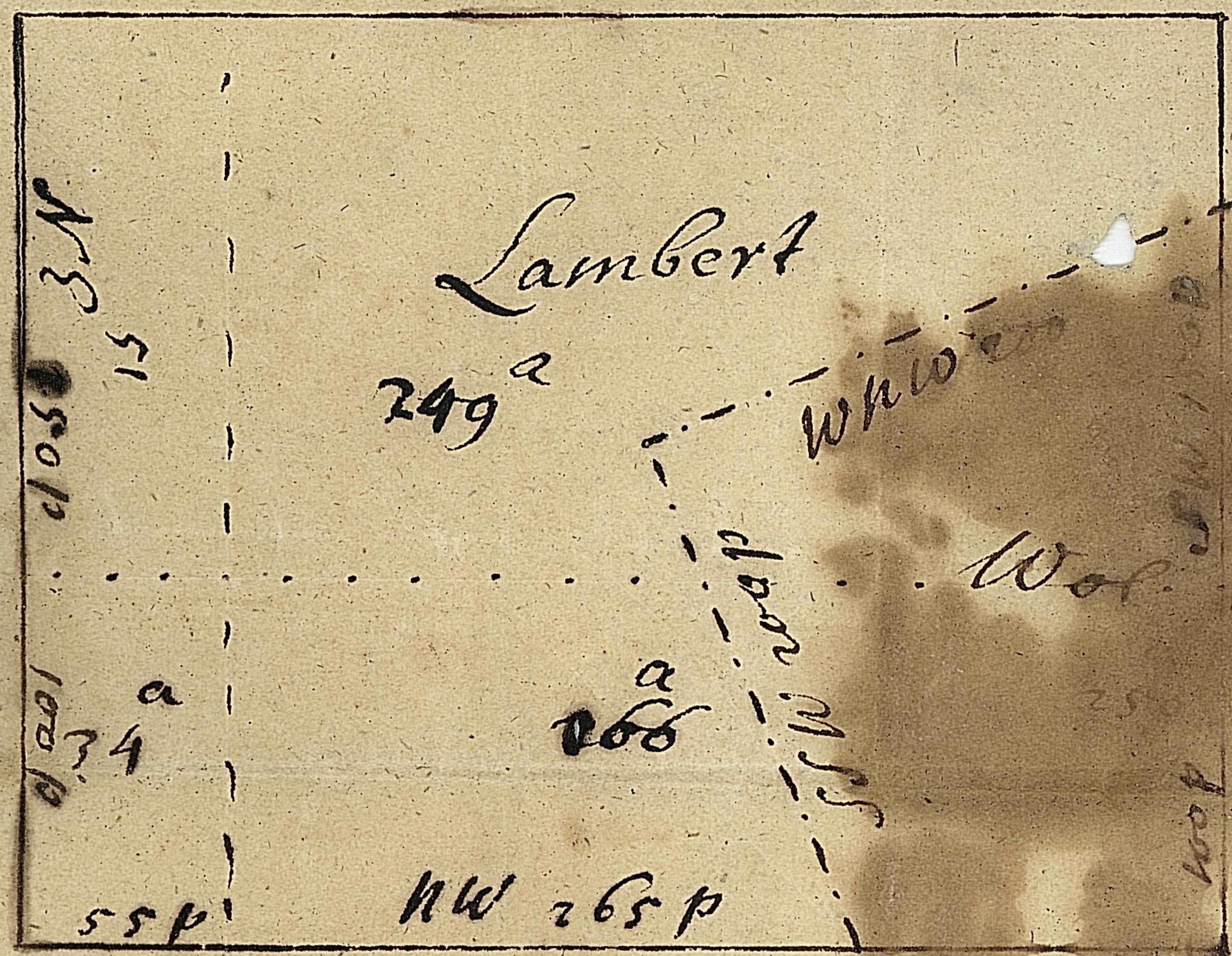

Lambert's addition
170^a

Lambert's Addition

Aug. 28th 1711

Begin at a bound. & Live Oak & S. cond tree of Wolvinton & run S 51° W 51 p
to Lambert & then with Lambert S E 170 p then N E 30 p then S E by E 64 p then E 26 p
then N by E 52 p then N 17° W 30 p to an old bound. & Live oak then N 27° W 140 p
then W 40 p then S 47° W 60 p then with a straight line to the first tree
Containing 170^a

Call Court's warrant for 1695^a dated March 10th 1710