

Maryland s^t. To the Honble his Lordships Agent at
December 6. Anno Dom. 1730

By virtue of a warrant for four hundred and thir-
ty five Acres of Land, bearing Date ~~the 12th Day of June last~~
the 12th Day of June last, granted in Common Form
unto M^r. William Homsley of Queen Anns County
as may appear &c

This may humbly Certifie that I Robert Forrest Wright Deputy
Surveyor of Queen Anns County, have surveyed and laid out for and
in the name of him the said William Homsley a tract of Land
Called Homsleys Adventure lying in the Horroff of Chester in Queen
Anns County, Beginning at a white Oak marked with fifteen notches
(viz) five, five and five, standing in a meadow on the North
East Side of a Thick Swamp or drain which Leads into a Branch
of Chester River Called Jordans Branch, and running from said
white Oak South Twenty four Degrees East one hundred and fifty
two perches, and South Eighty four Degrees East one hundred
and Twenty perches, and North Sixty three Degrees East forty perches
and North Twenty four Degrees East forty perches, and North fifty
Degrees West Eighteen perches, and North fifty four Degrees
West Eighty perches, and North Seven Degrees West fifty four
perches, and North Sixty five Degrees West Eighty six perches
and, West One hundred perches, and from thence with a
straight Line to the aforesaid white Oak, Containing and
now Laid out for Two hundred Acres of Land more or less,
to be held of the Mannor of Baltimore

True Copy &c

R Robert Forrest Wright
Deputy Surveyor of Queen Anns County

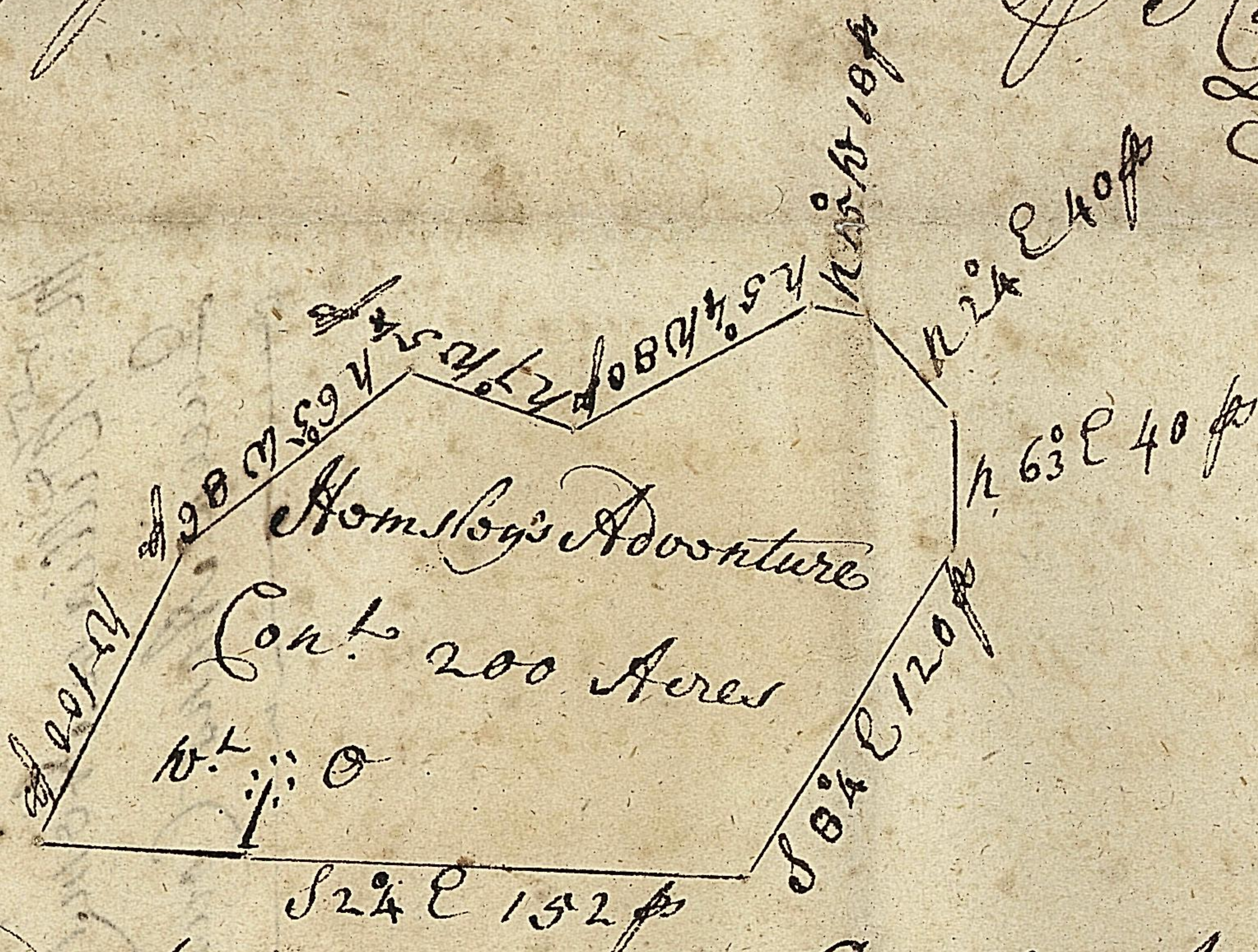

Plotted by a scale of 100 perches in an Inch
R Robert Forrest Wright
Deputy Surveyor of Queen Anns County