

Lines for part of a Tract of Land called Armo's Hermitage to be conveyed by Mrs Ann Earle
 to Benjamin Gould: Beginning at the original Beginning of said Tract commonly called
 Kemps Boundary and running from thence S 12. 15" E 41 ff until it intersects the fifth line
 of Joel Browns purchase called Spring Field and with that line S 86 E 114 ff to a
 Stand thence N 11 W 59 1/2 ff to the end of the ninth line of Williams Lot thence with
 that line reverse N W 62 ff to a Stand in the place of Peggy Davises Beginning &
 N 87 W 60 ff 6 S 25 W 7 ff and from thence a straight line to the Beginning
 Containing Fifty Six 3/4 Acres of Land more or less

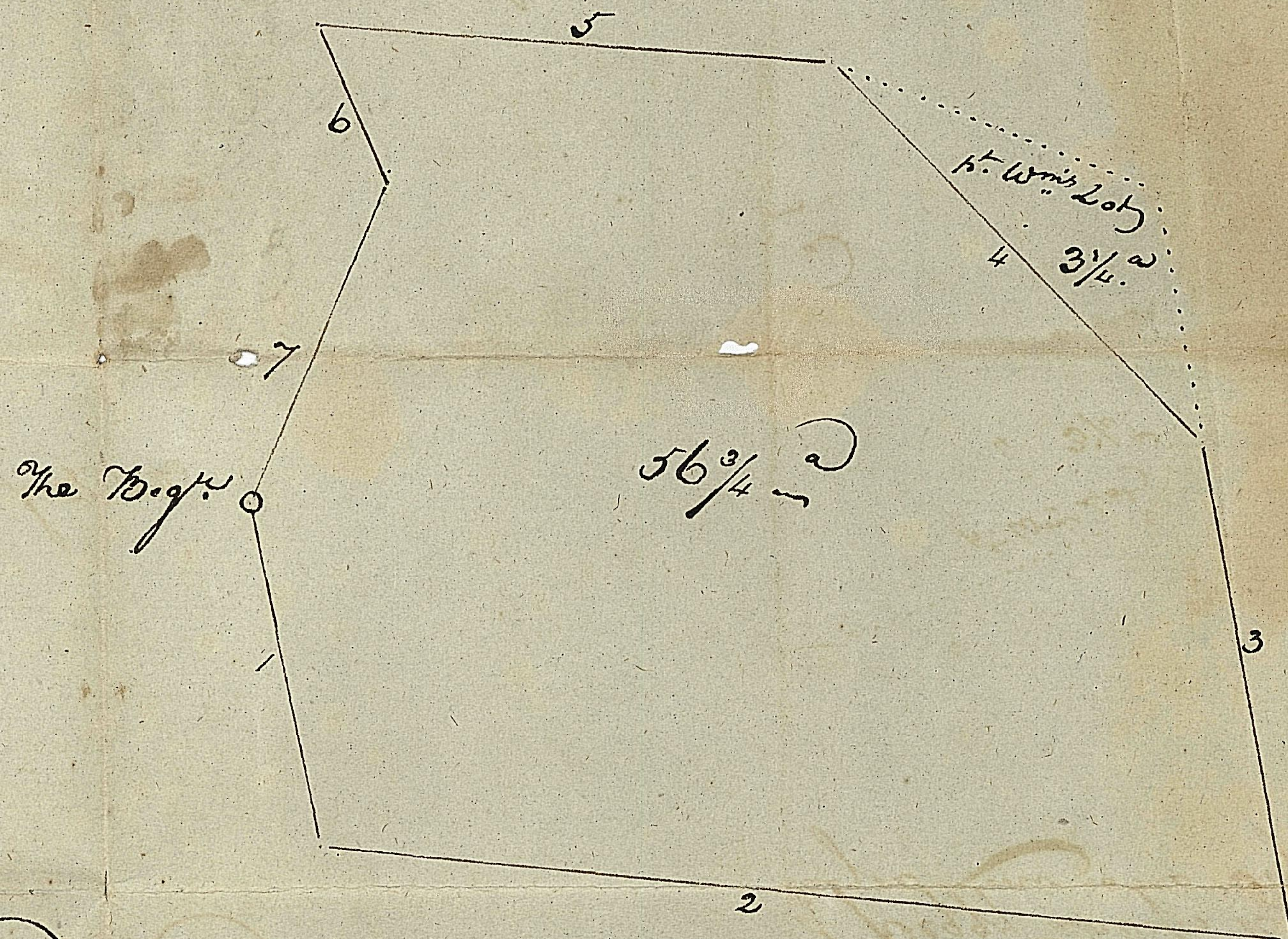

Plotted by a Scale of 30 ff. in an Inch

J. W. Hackett
 Nov. 21. 1796